

1. All boundaries, dimensions and levels are to be checked on site before construction and any discrepancies are to be reported to the Architect / Designer.
2. For the purpose of coordination, all relevant parties must check the information prior to implementation and report any discrepancies to the Architect / Designer.
3. Back and site plans are reproduced under license from the Ordnance Survey.
4. The drawings are the property of Lewis & Hickey and are not to be reproduced without written permission.
5. For the purpose of coordination, all relevant parties must check the information prior to implementation and report any discrepancies to the Architect / Designer.

Statutory Signage	
Running man symbol to BS 5499	
direction of escape route	
EX1	emergency exit light fitting - wall mounted
EX2	directional emergency light fitting - wall mounted
EX3	directional emergency light fitting - self/casting mounted
EX4	directional emergency light fitting - self/casting mounted
EX5	directional emergency light fitting - self/casting mounted
EX6	directional emergency light fitting - wall mounted
EX7	directional emergency light fitting - wall mounted
FS1	photoluminescent fire exit sign 300x150mm - wall mounted
FS2	photoluminescent fire exit sign 300x150mm - wall mounted
FS3	photoluminescent fire exit sign 300x150mm - wall mounted
FS4	photoluminescent fire exit sign 300x150mm - wall mounted
FS5	photoluminescent fire exit sign 300x150mm - wall mounted
FS6	photoluminescent fire exit sign 300x150mm - wall mounted
FS7	photoluminescent fire exit sign 300x150mm - wall mounted
FS8	photoluminescent fire exit sign 300x150mm - wall mounted
FS9	photoluminescent fire exit sign 300x150mm - wall mounted
FS10	photoluminescent fire exit sign 300x150mm - wall mounted
FS11	photoluminescent fire exit sign 300x150mm - wall mounted
FS12	photoluminescent fire exit sign 300x150mm - wall mounted
FS13	photoluminescent fire exit sign 300x150mm - wall mounted
FS14	photoluminescent fire exit sign 300x150mm - wall mounted
FS15	photoluminescent fire exit sign 300x150mm - wall mounted
FS16	photoluminescent fire exit sign 300x150mm - wall mounted
FS17	photoluminescent fire exit sign 300x150mm - wall mounted
FS18	photoluminescent fire exit sign 300x150mm - wall mounted
FS19	photoluminescent fire exit sign 300x150mm - wall mounted
FS20	photoluminescent fire exit sign 300x150mm - wall mounted
FS21	photoluminescent fire exit sign 300x150mm - wall mounted
FS22	photoluminescent fire exit sign 300x150mm - wall mounted
FS23	photoluminescent fire exit sign 300x150mm - wall mounted
FS24	photoluminescent fire exit sign 300x150mm - wall mounted
FS25	photoluminescent fire exit sign 300x150mm - wall mounted
FS26	photoluminescent fire exit sign 300x150mm - wall mounted
FS27	photoluminescent fire exit sign 300x150mm - wall mounted
FS28	photoluminescent fire exit sign 300x150mm - wall mounted
FS29	photoluminescent fire exit sign 300x150mm - wall mounted
FS30	photoluminescent fire exit sign 300x150mm - wall mounted
FS31	photoluminescent fire exit sign 300x150mm - wall mounted
FS32	photoluminescent fire exit sign 300x150mm - wall mounted
FS33	photoluminescent fire exit sign 300x150mm - wall mounted
FS34	photoluminescent fire exit sign 300x150mm - wall mounted
FS35	photoluminescent fire exit sign 300x150mm - wall mounted
FS36	photoluminescent fire exit sign 300x150mm - wall mounted
FS37	photoluminescent fire exit sign 300x150mm - wall mounted
FS38	photoluminescent fire exit sign 300x150mm - wall mounted
FS39	photoluminescent fire exit sign 300x150mm - wall mounted
FS40	photoluminescent fire exit sign 300x150mm - wall mounted
FS41	photoluminescent fire exit sign 300x150mm - wall mounted
FS42	photoluminescent fire exit sign 300x150mm - wall mounted
FS43	photoluminescent fire exit sign 300x150mm - wall mounted
FS44	photoluminescent fire exit sign 300x150mm - wall mounted
FS45	photoluminescent fire exit sign 300x150mm - wall mounted
FS46	photoluminescent fire exit sign 300x150mm - wall mounted
FS47	photoluminescent fire exit sign 300x150mm - wall mounted
FS48	photoluminescent fire exit sign 300x150mm - wall mounted
FS49	photoluminescent fire exit sign 300x150mm - wall mounted
FS50	photoluminescent fire exit sign 300x150mm - wall mounted
FS51	photoluminescent fire exit sign 300x150mm - wall mounted
FS52	photoluminescent fire exit sign 300x150mm - wall mounted
FS53	photoluminescent fire exit sign 300x150mm - wall mounted
FS54	photoluminescent fire exit sign 300x150mm - wall mounted
FS55	photoluminescent fire exit sign 300x150mm - wall mounted
FS56	photoluminescent fire exit sign 300x150mm - wall mounted
FS57	photoluminescent fire exit sign 300x150mm - wall mounted
FS58	photoluminescent fire exit sign 300x150mm - wall mounted
FS59	photoluminescent fire exit sign 300x150mm - wall mounted
FS60	photoluminescent fire exit sign 300x150mm - wall mounted
FS61	photoluminescent fire exit sign 300x150mm - wall mounted
FS62	photoluminescent fire exit sign 300x150mm - wall mounted
FS63	photoluminescent fire exit sign 300x150mm - wall mounted
FS64	photoluminescent fire exit sign 300x150mm - wall mounted
FS65	photoluminescent fire exit sign 300x150mm - wall mounted
FS66	photoluminescent fire exit sign 300x150mm - wall mounted
FS67	photoluminescent fire exit sign 300x150mm - wall mounted
FS68	photoluminescent fire exit sign 300x150mm - wall mounted
FS69	photoluminescent fire exit sign 300x150mm - wall mounted
FS70	photoluminescent fire exit sign 300x150mm - wall mounted
FS71	photoluminescent fire exit sign 300x150mm - wall mounted
FS72	photoluminescent fire exit sign 300x150mm - wall mounted
FS73	photoluminescent fire exit sign 300x150mm - wall mounted
FS74	photoluminescent fire exit sign 300x150mm - wall mounted
FS75	photoluminescent fire exit sign 300x150mm - wall mounted
FS76	photoluminescent fire exit sign 300x150mm - wall mounted
FS77	photoluminescent fire exit sign 300x150mm - wall mounted
FS78	photoluminescent fire exit sign 300x150mm - wall mounted
FS79	photoluminescent fire exit sign 300x150mm - wall mounted
FS80	photoluminescent fire exit sign 300x150mm - wall mounted
FS81	photoluminescent fire exit sign 300x150mm - wall mounted
FS82	photoluminescent fire exit sign 300x150mm - wall mounted
FS83	photoluminescent fire exit sign 300x150mm - wall mounted
FS84	photoluminescent fire exit sign 300x150mm - wall mounted
FS85	photoluminescent fire exit sign 300x150mm - wall mounted
FS86	photoluminescent fire exit sign 300x150mm - wall mounted
FS87	photoluminescent fire exit sign 300x150mm - wall mounted
FS88	photoluminescent fire exit sign 300x150mm - wall mounted
FS89	photoluminescent fire exit sign 300x150mm - wall mounted
FS90	photoluminescent fire exit sign 300x150mm - wall mounted
FS91	photoluminescent fire exit sign 300x150mm - wall mounted
FS92	photoluminescent fire exit sign 300x150mm - wall mounted
FS93	photoluminescent fire exit sign 300x150mm - wall mounted
FS94	photoluminescent fire exit sign 300x150mm - wall mounted
FS95	photoluminescent fire exit sign 300x150mm - wall mounted
FS96	photoluminescent fire exit sign 300x150mm - wall mounted
FS97	photoluminescent fire exit sign 300x150mm - wall mounted
FS98	photoluminescent fire exit sign 300x150mm - wall mounted
FS99	photoluminescent fire exit sign 300x150mm - wall mounted
FS100	photoluminescent fire exit sign 300x150mm - wall mounted

## for information

00 19ap07 issued for information me GG

REV DATE DESCRIPTION DPN CHKD

CLIENT

PROJECT

Asioli Estate, Guildford, UK

Warehouse Statutory Signage Plans

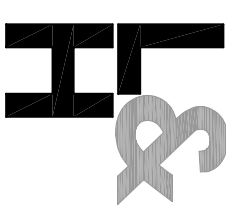

18 Farnham Road  
Guildford  
Surrey, GU1 4AA  
Tel: 01483 590 998  
Fax: 01483 590 880  
Email: guildford@lewishickey.com

SCALE DATE DRAWN CHECKED  
1:125 Apr 07 me GG  
PROJECT No DRAWING No STATUS REV  
G2904 148 I 00

Warehouse Statutory Signage – Mezzanine

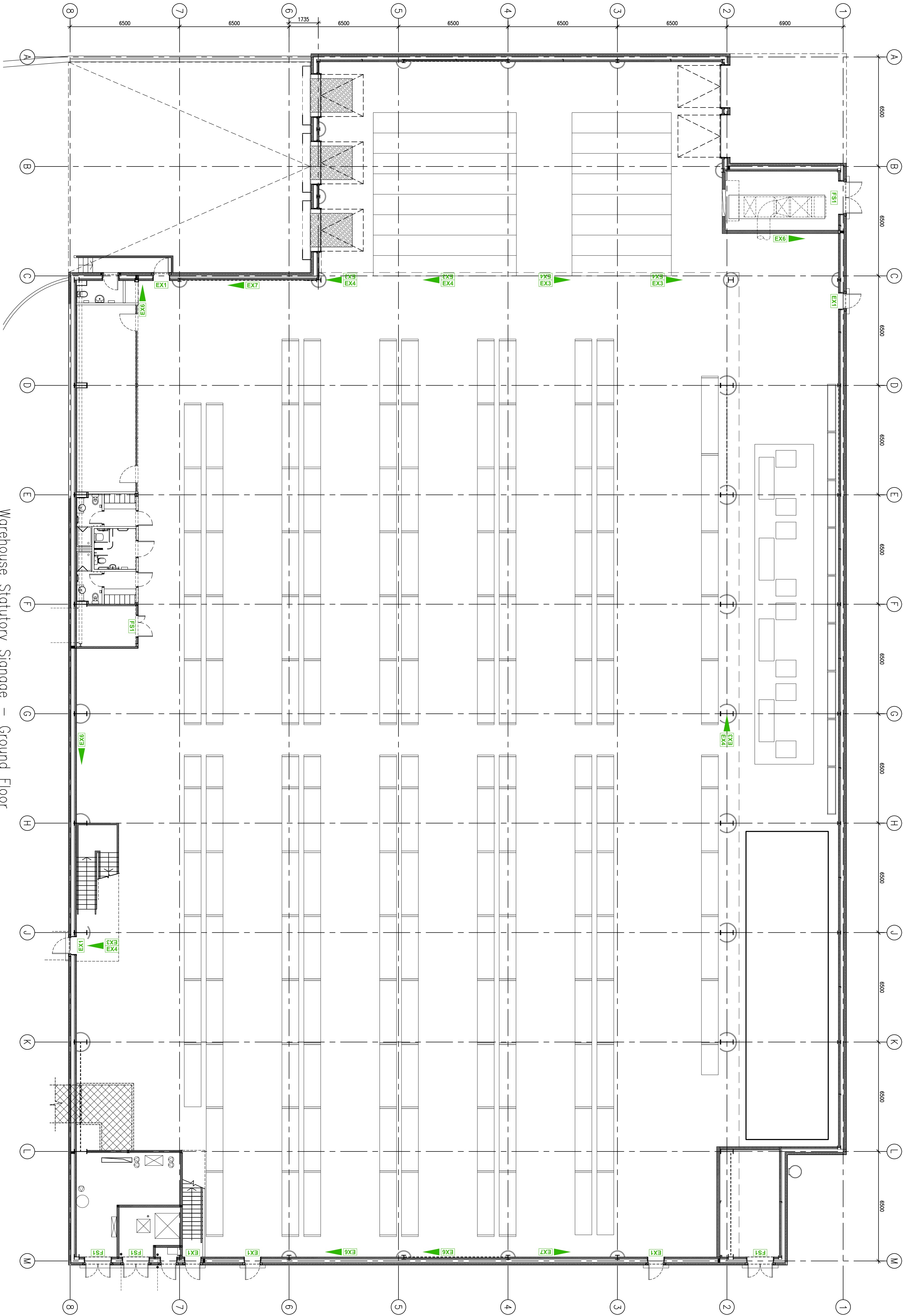

Warehouse Statutory Signage – Ground Floor

